

CUTTING HEAD ALIGNMENT

Remove 1 (one) end piece to free chrome bar for head alignment

1. Turn cutter over & remove 2 (two) Phillip-head screws securing end piece
2. Slide end piece off to release chrome bar

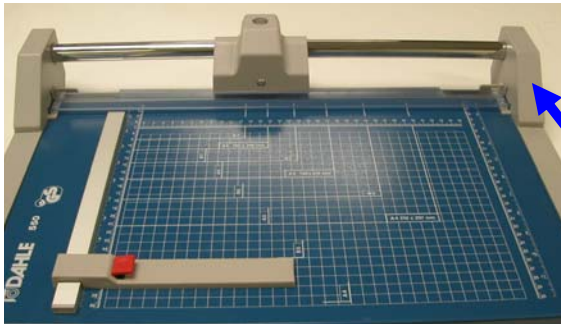

End Piece

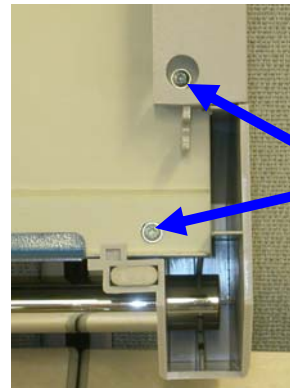

Screws

Align cutting head

1. Twist head *slightly* away from board so that rubber wheel is running ON the plastic clamp & blade is running NEXT TO the base as shown in pictures below

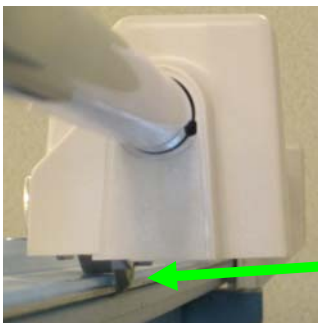

CORRECT

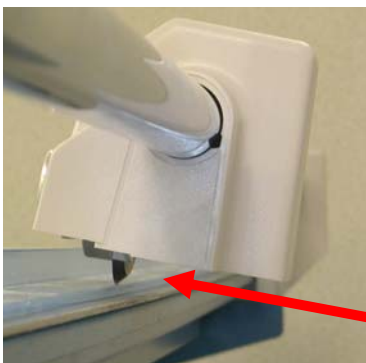
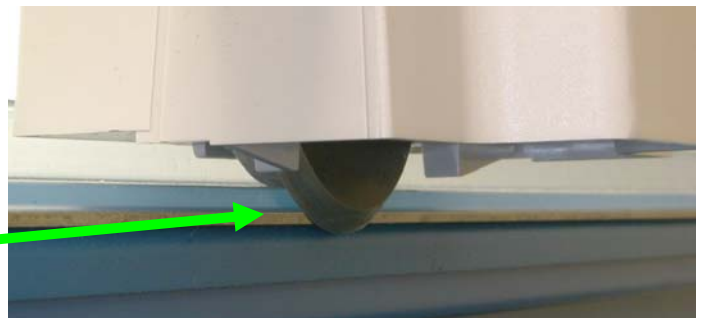

INCORRECT

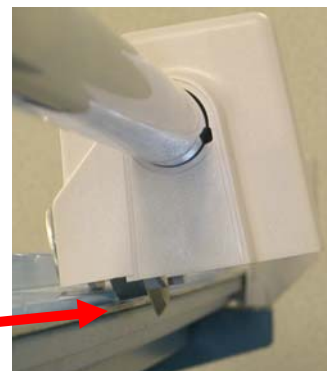

Install end piece & 2 (two) screws previously removed

- Before cutting, run head back & forth several times to be sure it is moving smoothly